

140H Differential and Bevel Gear Repair Options

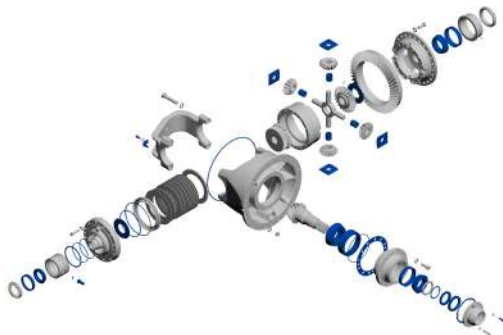

PLANNED/PROBLEM INDICATORS

- Component hours
- Differential oil leak
- S•O•SSM report
- Noise or vibration
- Failure of another component within same oil system
- Machine down for other work

PART OR SERVICE INCLUDED

- All bushings and anti-friction bearings
- All seals and gaskets
- All thrust washers/spacers
- Miscellaneous hardware (as needed)

INSPECTION POINTS

- Gears
- Bevel pinion shaft
- Limited slip clutch discs and plates
- Limited slip clutch piston and housing
- Differential spider
- Differential case assembly
- Operation test

Level 1 Rebearing/Reseal

- >> Provides new component life (if other parts meet reusability guidelines)
- >> Guaranteed price
- >> Reduces costs
- >> Reduces downtime

BUILT FOR IT.

\$ 1,202.27

LEVEL 2 ADD-ONS Salvage or Replace	Estimated Price
Bevel gear	\$
Bevel pinion shaft	\$
Differential spider gears	\$
Differential side gears	\$
Differential spider	\$
Limited slip clutch discs	\$
Limited slip clutch plates	\$
Limited slip clutch piston	\$
Limited slip clutch housing	\$
Differential case assembly	\$

Warranty _____
Customer Name _____
Contact Phone No. _____
Date _____
Model _____
Serial No. _____
Total Estimated Price _____
Sales Person _____
Contact Phone No. _____
Turn Around Time _____

(SMCS code 02A for Level 1, 02B for Level 2)



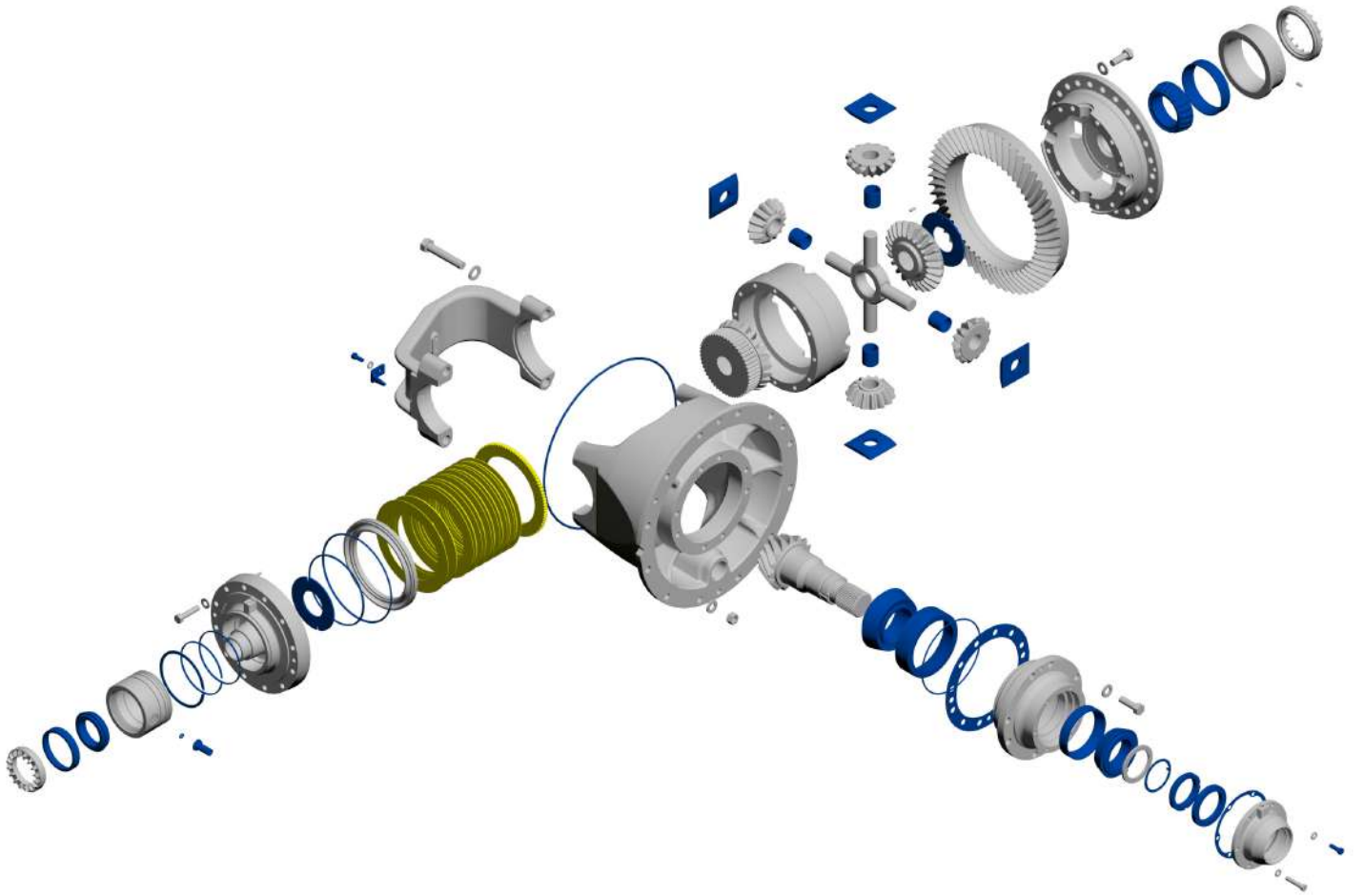

Level 1 - blue
Level 2 - yellow